

Dual Enrollment Opportunities

DISTRICT FIVE SCHOOLS OF SPARTANBURG COUNTY

Scholars Academy



2

- ▶ University of South Carolina – Upstate awards transferrable college credit
- ▶ Serves high school students enrolled in all Spartanburg County public schools
- ▶ Students must enter in Fall of their 9th grade year
- ▶ Students attend 75% of their classes at Upstate and 25% at their high school
- ▶ Offers college classes & advanced high school classes
- ▶ Students earn up to 60 college credits while completing all high school graduation requirements in 3 years
- ▶ Students participate in their high school's extra curricular activities, sports, clubs, etc.

Scholars Academy



3

▶ Requirements

- ▶ Maintain A's & B's in all courses
- ▶ Begin as a ninth grade student
- ▶ Commit to graduate the program
- ▶ Be self-motivated, academically driven
- ▶ Have parent support
- ▶ Be mature

Scholars Academy



4

- ▶ Typical Academic Profile
 - ▶ Gifted/Talented student
 - ▶ Successful student in English 1 (8th grade)
 - ▶ Successful student in Algebra 1 (7th/8th grade)
 - ▶ Exemplary PASS
 - ▶ MAP – above grade level
 - ▶ High academic achiever

Scholars Academy



5

- ▶ Typical Personal Profile
 - ▶ Wide range of interests and pursuits both in and out of school
 - ▶ Intellectually curious and a creative thinker
 - ▶ Seeks and thrives on challenge
 - ▶ Is able to work independently
 - ▶ Trustworthy and mature

Scholars Academy



6

▶ Selection Process

- ▶ Begins in the 8th grade
- ▶ Parents/students are informed of the program at IGP conferences, parent conferences, flyers, school newsletters, school websites, and informational letter and brochure from the Scholars Academy
- ▶ Multiple information seminars for parents/students are hosted at USC Upstate
- ▶ Students/parents complete an application packet and submit to his/her guidance counselor
 - ▶ Guidance counselor completes the report/application and submits to USC Upstate
- ▶ Applications are ranked by committee according to rubric
- ▶ Top applicants are invited to interview with committee
- ▶ Based on interview and application, top students are invited to participate

Scholars Academy



7

- ▶ Ranking Applicants
 - ▶ 15% - PSAT
 - ▶ 15% - Recommendations
 - ▶ 15% - Essay
 - ▶ 15% - Grades
 - ▶ 10% - EXPLORE/PASS
 - ▶ 10% - Attendance
 - ▶ 10% - Behavior
 - ▶ 10% - Aptitude and/or Achievement scores (only 1 – highest)
- ▶ Total application score calculated



Scholars Academy



- ▶ Student Interviews
 - ▶ Interview teams comprised of 3-5 educators from USC Upstate and Spartanburg County Schools
 - ▶ Rubric used to calculate student's interview score
- ▶ Student's final score = interview score + application score
- ▶ All Spartanburg County applicants ranked
- ▶ Top students invited to join Scholars Academy
 - ▶ Typically 35 students each year

Scholars Academy

Spartanburg 5 Enrollment History



9

Graduating Class →	2011	2012	2013	2014	2015	2016	2017	2018
Cohort	1	2	3	4	5	6	7	8
Applied	6	29	32	26	25	28	34	33
Interviewed	4	10	9	14	10	13	14	15
Invited	3	9	7	10	7	11	5	
Started	3	9*	7	10	7	11	5	
Attending				5	7	8	5	
Completed & Graduated	1	4	2					

* One student transferred to another Spartanburg County District and completed the program

Scholars Academy

Spartanburg 5 Graduate College Selection



10

	2011	2012	2013	2014	2015	2016	2017	2018
College of Charleston			1					
College of Charleston Honors College		1						
University of South Carolina		1						
USC Honors College		2	1					
Winthrop University	1							

Scholars Academy

Tuition, Fees, Salaries, and Benefits



11

- ▶ District (24 students enrolled in 2013-14)
 - ▶ Tuition: \$1,320 per student for 2013-14
 - ▶ 2013-14 Total - \$31,680.00
 - ▶ Textbooks for Cohorts 4, 5 & 6 (Class of 2014, 2015, 2016)
 - ▶ Fall 2013 Total - \$2,693.42, Spring 2014 Total - \$2,184.78
 - ▶ Bus transportation originating in District 5, two round trips daily to Upstate
 - ▶ 2013-2014 Total: \$5,950.00 Salaries & Benefits, \$19,215.00 Bus Transportation
 - ▶ PE 1 High School credit in District 6 summer school - \$250.00 per student 2013-14
 - ▶ 2013-2014 Total: \$1,250.00
 - ▶ Director and Support Staff Salaries & Benefits: \$1,595.14 per student for 2013-14
 - ▶ 2013-14 Total: \$38,283.32
 - ▶ **District Total 2013-14: \$101,256.52 or \$4,219.02 /student, 24 students**

Scholars Academy

Tuition, Fees, Salaries, and Benefits



12

- ▶ Parent/Guardian
 - ▶ Textbooks and support materials (Ex. Lab coat, etc.)
 - ▶ Cohort 7 and after (Class of 2017 and after)

Spartanburg Community College

SCC Tyger River Campus

13

- ▶ Spartanburg Community College awards transferrable college credit
 - ▶ Courses/colleges listed on South Carolina Transfer and Articulation Center Website (SC Trac)
<http://www.sctrac.org/SCTRAC/tabid/411/Default.aspx>
- ▶ Students register for courses in pairs (3 hours each)
- ▶ Parents/students are made aware through the registration process, at IGP meeting, in the course of study catalog
- ▶ Parent/student informational meetings are held at Byrnes High School to give an overview of SCC dual credit opportunities, and assist in the registration process
- ▶ Students must earn final grade of "A", "B" or "C" for transfer credit

Spartanburg Community College

SCC Tyger River Campus

14

Fall 2014 Schedule

TIME/DAY	MONDAY/WEDNESDAY	TUESDAY/THURSDAY
8:00 – 9:20 A.M.	English Composition I (ENGL 101)	English Composition I (ENGL 101)
8:00 – 9:20 A.M.	General Psychology (PSY 201)	Medical Vocab/Anatomy (AHS 104)
8:00 – 9:20 A.M.	Medical Terminology (AHS 102)	Probability and Statistics (MAT 120)
2:00 – 3:20 P.M.	Introduction to Computers (CPT 101)	Introduction to Sociology (SOC 101)
2:00 – 3:20 P.M.	Music Appreciation (MUS 105)	Public Speaking (SPC 205)

Spartanburg Community College

SCC Tyger River Campus

15

Spring 2015 Schedule

TIME/DAY	MONDAY/WEDNESDAY	TUESDAY/THURSDAY
8:00 – 9:20 A.M.	English Composition I (ENGL 101)	College Algebra (MAT 110)
8:00 – 9:20 A.M.	Medical Terminology (AHS 102)	Medical Terminology (AHS 102)
8:00 – 9:20 A.M.	Macroeconomics (ECO 210)	Western Civilization Post 1689 (HIS 102)
2:00 – 3:20 P.M.	General Psychology (PSY 201)	Introduction to Computers (CPT 101)
2:00 – 3:20 P.M.	Public Speaking (SPC 205)	Art History and Appreciation (ART 101)

Spartanburg Community College

SCC Tyger River Campus

16

- ▶ Eligibility and Admission Criteria
 - ▶ Student must be classified as a junior or senior
 - ▶ Student must complete SCC application and all paperwork
 - ▶ SAT: Critical Reading 480 and Math 480 or
 - ▶ ACT: English 19 and Math 19
 - ▶ Students without SAT or ACT scores can substitute an ASSET or COMPASS score
 - ▶ Minimum score varies by course
 - ▶ Students must meet all prerequisite course requirements
 - ▶ Ex. English 101 is a prerequisite for English 102
 - ▶ Parents/students provide own transportation; however, transportation can be provided upon request
 - ▶ Guidance counselor approval

Spartanburg Community College

SCC Tyger River Campus

17

- ▶ ASSET – A testing and advising program from ACT for placing students into postsecondary institutions.
 - ▶ Given to all juniors yearly
 - ▶ Paper and pencil format
 - ▶ Used by over 400 community and technical colleges
 - ▶ Required Scores --- Reading: 37-41, Writing: 36-44, Elementary Algebra: 42, Intermediate Algebra: 44, Numerical Skills: 41
- ▶ COMPASS – Computer-adaptive placement test from ACT
 - ▶ Administered at main SCC Campus and at the Tyger River Campus
 - ▶ Required Scores --- Reading: 69-81, Writing: 42-78, Pre-Algebra: 44, Algebra 47-66
 - ▶ Installing at Byrnes High School and will replace ASSET

Spartanburg Community College

SCC Tyger River Campus

18

- ▶ Tuition and Fees
 - ▶ Parent/Student
 - ▶ \$390.00 for 6.0 credit hours with Lottery Tuition Assistance
 - ▶ \$65.00 per credit hour
 - ▶ Must complete the Lottery Tuition Assistance FASFA Waiver Form
 - ▶ Required textbooks

Spartanburg Community College

Byrnes High School Campus

19

- ▶ Course Opportunities
 - ▶ English 101 – English Composition 1
 - ▶ English 102 – English Composition 2
 - ▶ Math 110 – College Algebra I
 - ▶ Math 120 – College Probability and Statistics
 - ▶ Biology 101 – Biological Sciences I
- ▶ Eligibility and Admission Criteria
 - ▶ Same as Tyger River Campus Courses plus
 - ▶ Earned 4 English credits, 4 Math credits, and Biology/Chemistry credits respectively

Spartanburg Community College

Byrnes High School Campus

20

- ▶ Tuition and Fees
 - ▶ Parent/Student
 - ▶ Tuition \$30.00 per 3 hour course (\$10.00 per hour)
 - ▶ Biology \$40.00 per 4 hour course
 - ▶ Lab workbook: Estimate \$50.00
 - ▶ Required textbook: Estimate \$150.00 all courses
 - ▶ Student tuition is lower since qualified/approved Byrnes High School teachers will instruct each class
 - ▶ District
 - ▶ Typical teacher salary equivalent to any course taught in high school

Spartanburg Community College

RD Anderson Applied Technology Center

21

- ▶ Dual Credit Opportunities – Tuition and Fees
 - ▶ Health Science 2 - \$20.00
 - ▶ Medical Terminology for the Healthcare Professional - \$30.00
 - ▶ Nursing Assisting - \$50.00
 - ▶ Carpentry III - \$40.00 (Greenville Technical College)
 - ▶ Machine Tool Technology IIA, IIB - \$70.00
 - ▶ Welding II - \$40.00
 - ▶ Welding III - \$40.00
 - ▶ Automotive Technology - \$20.00 (Greenville Technical College)
 - ▶ Automotive Collision Repair I - \$20.00 (Greenville Technical College)
 - ▶ Automotive Collision Repair IIA, IIB - \$20.00 (Greenville Technical College)

Spartanburg Community College

RD Anderson Applied Technology Center

22

- ▶ Eligibility and Admission Criteria
 - ▶ Classified as junior or senior
 - ▶ United States citizen
 - ▶ Meet minimum score on ASSET or COMPASS
 - ▶ Successfully complete all prerequisite courses
 - ▶ Student must complete SCC application and all paperwork
- ▶ Tuition and Fees
 - ▶ Parent/Student
 - ▶ Tuition \$10.00 per credit hour
 - ▶ Supplies specific to course
 - ▶ \$40.00 coverall fee, etc.
 - ▶ Must complete the Lottery Tuition Assistance FASFA Waiver Form

Spartanburg Community College

RD Anderson Applied Technology Center

23

- ▶ Student Certification and Licensure
 - ▶ Cosmetology - South Carolina State Cosmetology License
 - ▶ CNA - Certified Nursing Assistant
 - ▶ Fire/EMS - First Responder Certification
 - ▶ Culinary Arts - ServSafe Certification (food and beverage safety training program)
 - ▶ Automotive Technology - AYES Certification (Automotive Youth Educational System – GM, entry level service tech)
 - ▶ Automotive Collision Repair - ICAR Training (Inter-Industry conference of Auto Collision Repair)
 - ▶ Health Science - American Heart CPR Certification

University of South Carolina - Upstate

Byrnes High School Campus

24

- ▶ Teacher Cadet Honors Program
 - ▶ Students select dual enrollment option
 - ▶ Selection Criteria
 - ▶ Cumulative B average
 - ▶ Enrolled in all college prep courses
 - ▶ Written essay
 - ▶ Good standing with attendance and discipline
 - ▶ Complete school application
 - ▶ Complete USC-Upstate application and all paperwork
 - ▶ Cost to parent/student: \$200.00 for 3 credit hours (\$66.67/hr.)
 - ▶ Students earn credit for SEDF 210: Foundations of Education



University of South Carolina

USC Upstate Campus

New for 2014-15

- ▶ SC Upstate awards transferrable college credit
 - ▶ Courses/colleges listed on South Carolina Transfer and Articulation Center Website (SC Trac)
<http://www.sctrac.org/SCTRAC/tabid/411/Default.aspx>
- ▶ Students register for courses in pairs (3 hours each)
- ▶ Parents/students are made aware through the registration process, at IGP meeting, in the course of study catalog
- ▶ Parent/student informational meetings are held at Byrnes High School to give an overview of USC- Upstate dual credit opportunities, and assist in the registration process

University of South Carolina

USC Upstate Campus

26

Fall 2014 Schedule

TIME/DAY	MONDAY/WEDNESDAY/FRIDAY	TIME/DAY	TUESDAY/THURSDAY
8:00 – 8:50 A.M.	English Composition I (ENGL 101)	8:00 – 9:15 A.M.	Introduction to Psychology (PSY 101)
8:00 – 8:50 A.M.	Introduction to Computer Technology (CSCI 138)	8:00 – 9:15 A.M.	Introduction to World History II (HIS 102)
8:00 – 8:50 A.M.	History of Rock Music (MUSC 140)	8:00 – 9:15 A.M.	Elementary Statistics (MAT 102)
	MONDAY/WEDNESDAY		TUESDAY/THURSDAY
2:00 – 3:15 P.M.	Introduction to Psychology (PSY 101)	2:00 – 3:15 P.M.	English Composition I (ENGL 101)
2:00 – 3:15 P.M.	Introduction to World History II (HIS 102)	2:00 – 3:15 P.M.	Introduction to Computer Technology (CSCI 138)
2:00 – 3:15 P.M.	Elementary Statistics (MAT 102)	2:00 – 3:15 P.M.	History of Rock Music (MUSC 140)

University of South Carolina

USC Upstate Campus

27

Spring 2015 Schedule

TIME/DAY	MONDAY/WEDNESDAY/FRIDAY	TIME/DAY	TUESDAY/THURSDAY
8:00 – 8:50 A.M.	English Composition II (ENGL 102)	8:00 – 9:15 A.M.	Introduction to Psychology (PSY 101)
8:00 – 8:50 A.M.	Introduction to Computer Technology (CSCI 138)	8:00 – 9:15 A.M.	Introduction to World History II (HIS 102)
8:00 – 8:50 A.M.	History of Rock Music (MUSC 140)	8:00 – 9:15 A.M.	College Algebra (MAT 121)
	MONDAY/WEDNESDAY		TUESDAY/THURSDAY
2:00 – 3:15 P.M.	Introduction to Psychology (PSY 101)	2:00 – 3:15 P.M.	English Composition II (ENGL 102)
2:00 – 3:15 P.M.	Introduction to World History II (HIS 102)	2:00 – 3:15 P.M.	Introduction to Computer Technology (CSCI 138)
2:00 – 3:15 P.M.	College Algebra (MAT 121)	2:00 – 3:15 P.M.	History of Rock Music (MUSC 140)

University of South Carolina

USC Upstate Campus

- ▶ Eligibility and Admission Criteria
 - ▶ Student must be classified as a junior or senior
 - ▶ Student must complete USC Upstate application and all paperwork
 - ▶ Parents/students provide own transportation; however, transportation can be provided upon request
 - ▶ GPA: 3.0 ("B" average)
 - ▶ Guidance counselor approval

University of South Carolina

USC Upstate Campus

29

- ▶ Tuition and Fees
 - ▶ Parent/Student
 - ▶ \$396.00 for 6.0 credit hours
 - ▶ \$66.00 per credit hour
 - ▶ Required Textbooks





UPSTATE
University of South Carolina Upstate

Fall 2014 High School Dual Enrollment

Want to get a jump- start on college?

Get ahead at USC Upstate!

With USC Upstate's Dual Enrollment Program, you can start earning college credit while you're still in high school!

What courses can I take?

Mon., Wed., Fri.: 8:00 a.m. - 8:50 a.m.
OR Tues., Thurs.: 2:00 p.m. - 3:15 p.m.

ENGL 101: English Composition I

CSCI 138: Intro to Computer Technology

MUSC 140: History of Rock Music

Mon., Wed.: 2:00 p.m. - 3:15 p.m.
OR Tues., Thurs.: 8:00 a.m. - 9:15 a.m.

PSYC 101: Intro to Psychology

HIST 102: Intro to World History II

MATH 102: Elementary Statistics

How much does it cost?

The cost of a course is \$198.

Are there any requirements? How do I get started?

You must have a B average in order to enroll in any dual enrollment courses.

To get started, simply fill out the dual enrollment application online at www.uscupstate.edu and send us a letter of recommendation from your high school guidance counselor.

For more information, follow the link at www.uscupstate.edu/admissions or contact Donette Stewart, dstewart@uscupstate.edu or 864-503-5246!

There will be an informational session at Byrnes for parents on January 30 at 6:30 p.m.

Spartanburg County Early College High School: SCC Main Campus

31



New for 2014-15

Spartanburg County Early College High School (SCECHS) at Spartanburg Community College (SCC) is an innovative partnership between the seven Spartanburg County School Districts and SCC. The program was developed to graduate students with a high school diploma and the first two years of transferable college credit or associate degree in preparation for high growth, high demand jobs of the 21st century.

Spartanburg County Early College High School: SCC Main Campus

32



The Program serves students who ...

- ▶ Are at risk of dropping out of school before attaining a high school diploma
- ▶ Would benefit from accelerated academic instruction
- ▶ Are the first in their immediate family to attend college
- ▶ Are from groups historically under-represented in postsecondary education
- ▶ Are economically disadvantaged students.

Spartanburg County Early College High School: SCC Main Campus

33



Program Goals:

- ▶ To Improve Graduation Rates
- ▶ Make Higher Education Accessible and Affordable
- ▶ Provide Guidance and Support
- ▶ Facilitate the Transition to Higher Education
- ▶ Offer Innovative Program

Student Outcomes:

- ▶ Students earn 60 hours of transferrable credit
 - ▶ Graduates enter a four year college or university
 - ▶ Graduates enter work force with an Associate of Arts Degree

Spartanburg County Early College High School: SCC Main Campus Selection Criteria

34



Factors used for selecting student:

- ▶ Rising ninth grade students
- ▶ Students with high academic potential
- ▶ Average to high test scores
- ▶ 2.0 - 3.5 grade point average (GPA)
- ▶ College potential with support
- ▶ Desire and determination
- ▶ Self directed and focused
- ▶ No behavioral issues

Students must meet one or more of the following criteria:

- ▶ First in immediate family to attend college
- ▶ Historically underserved in postsecondary education
- ▶ Low income
- ▶ Special circumstances



Freshman		Sophomore		Junior		Senior	
Fall Semester	Spring Semester	Fall Semester	Spring Semester	Fall Semester	Spring Semester	Fall Semester	Spring Semester
ENG 100 (SCC)	RDG 100 (SCC)	ENG 101 (SCC)	ENG 102 (SCC)	BIO 101 (SCC)	ECO 211 (SCC)	ENG 200 (SCC)	SPC 205 (SCC)
MAT 031 (SCC)	MAT 032 (SCC)	MAT 101 (SCC)	MAT 102 (SCC)	MAT 110 (SCC)	MAT 111 (SCC)	F. Lang 101 (SCC)	F. Lang 102 (SCC)
ALG I (HS)	Geometry (HS)	HIS 201 (SCC)	HIS 202 (SCC)	PSC 201 (SCC)	CPT 101 (SCC)	CHM 110 (SCC)	Elective (SCC)
AVID 101 (HS)	Avid 102 (HS)	AVID 201 (HS)	AVID 202 (HS)	AVID 301 (HS)	AVID 301 (HS)	AVID 401 (HS)	AVID 402 (HS)
ENG I (HS)	COL 101	BIO 100 (SCC)		Elective (SCC)	Humanities / Fine Arts (SCC)	Elective (SCC)	Elective (SCC)

- Students attend classes at SCC: 8:30 AM – 3:00 PM
- Blend of college and high school credit classes
- Participation in extracurricular activities encouraged
- Bus transportation provided

Student must take and pass both portions of HSAP – SC Exit Exam				<div>High School Diploma Credits</div> <table><tr><td>English</td><td>4</td></tr><tr><td>Math</td><td>4</td></tr><tr><td>Science</td><td>3</td></tr><tr><td>U.S. History</td><td>1</td></tr><tr><td>Economics</td><td>.5</td></tr><tr><td>U.S. Govt</td><td>.5</td></tr><tr><td>Other S.Studies</td><td>1</td></tr><tr><td>PE or ROTC</td><td>1</td></tr><tr><td>Comp Sci</td><td>1</td></tr><tr><td>F. Lang</td><td>1</td></tr><tr><td>Electives</td><td>7</td></tr><tr><td colspan="2">-----</td></tr><tr><td colspan="2">24 total</td></tr></table>	English	4	Math	4	Science	3	U.S. History	1	Economics	.5	U.S. Govt	.5	Other S.Studies	1	PE or ROTC	1	Comp Sci	1	F. Lang	1	Electives	7	-----		24 total		<div>SCC Credits</div> <div>*See attached course list for earning an Associate in Arts degree.</div> <div>36</div> <div></div>
English	4																														
Math	4																														
Science	3																														
U.S. History	1																														
Economics	.5																														
U.S. Govt	.5																														
Other S.Studies	1																														
PE or ROTC	1																														
Comp Sci	1																														
F. Lang	1																														
Electives	7																														

24 total																															
<div>Proposed Freshman Schedule:</div> <div>8:30-10:00 M-F</div> <div>10:10-11:40 M-F</div> <div>11:50-12:50 Lunch/AVID</div> <div>1:00-2:20 SCC Courses (M/W, T/Th)</div>	<div>Summer Before Freshman Year: Students will take PE course online and participate in team building activities as well as orientation sessions. The Dean for the SCECHS will plan meaningful service learning opportunities for these students throughout the year.</div> <div>Target Students: at-risk, average to high test scores, 2.0-3.5 GPA, college potential with support, first generation to go to college, low income</div>																														

Spartanburg County Early College High School: SCC Main Campus

37



Selection and Enrollment Process

- ▶ Students are nominated by guidance counselor, teacher or administrator
- ▶ Nominated students and parents invited to attend informational session at SCC
- ▶ Students and parents complete and submit application
- ▶ Students are administered COMPASS test
- ▶ Applications scored by committee based on rubric
- ▶ Top candidates invited to interview with committee
- ▶ Top 25 county-wide candidates invited to participate
- ▶ Students complete all enrollment forms for SCC

Spartanburg County Early College High School: SCC Main Campus

38



- ▶ Ranking Applicants
 - ▶ GPA: 0 – 20 points
 - ▶ Discipline: -20 – 20 points
 - ▶ Poverty index: 0 – 20 points
 - ▶ First to attend college: 15 – 20 points
 - ▶ Special circumstances: 10 – 20 points
 - ▶ Attendance: deductions based on absence types
 - ▶ Recommendations: 15 – 20 points
 - ▶ Writing sample: 15 points
- ▶ Total application score calculated



Spartanburg County Early College High School: SCC Main Campus

39



▶ Tuition and Fees: District

- ▶ Tuition: Based on number of students selected from Spartanburg Five
 - ▶ 2014-15 Estimate: \$1,084.00 per student (\$3,252.00 total – 3 students)
 - ▶ See cost structure slide/page 41
- ▶ Textbooks: 2014-15 Estimate: \$3,150.00
- ▶ PE 1 High School credit in District 6 summer school - \$250.00 per student 2013-14
 - ▶ 2014-15 Estimate: \$750.00
- ▶ Transportation:
 - ▶ \$5,819.40 added to Scholars Academy mileage
 - ▶ \$1,700.00 added to Scholars Academy salary and benefits
- ▶ Director and support staff salary and benefits
 - ▶ 2014-15 Estimate: \$6,584.73 (1 student), \$13,169.46 (2 students), \$19,754.20 (3 students)
- ▶ AVID: 2014-15 Estimate: \$2,500.00 year 1
- ▶ **District Estimate 2014-15: \$36,925.60**

Spartanburg County Early College High School: SCC Main Campus

40



Tuition and Fees

- ▶ Students/Parents
 - ▶ No tuition, books or fee costs



Cost Structure

41



	Grade	# Students	College Credits	Current \$/credit h.	Tuition	LTA	Net	Enrollment Fee \$50/student/sem.	School total
First Year	9th	25	12	\$ 169	\$ 50,700	\$ 26,100	\$ 24,600	\$ 2,500	\$ 27,100
					Average cost per student				\$ 1,084
Second Year	9th	25	12	\$ 169	\$ 50,700	\$ 26,100	\$ 24,600	\$ 2,500	
	10th	25	15	\$ 169	\$ 63,375	\$ 32,625	\$ 30,750	\$ 2,500	
		50	27		\$ 114,075	\$ 58,725	\$ 55,350	\$ 5,000	\$ 60,350
					Average cost per student				\$ 1,207
Third Year	9th	25	12	\$ 169	\$ 50,700	\$ 26,100	\$ 24,600	\$ 2,500	
	10th	25	15	\$ 169	\$ 63,375	\$ 32,625	\$ 30,750	\$ 2,500	
	11th	25	24	\$ 169	\$ 101,400	\$ 52,200	\$ 49,200	\$ 2,500	
		75	51		\$ 215,475	\$ 110,925	\$ 104,550	\$ 7,500	\$ 112,050
					Average cost per student				\$ 1,494
Fourth Year	9th	25	12	\$ 169	\$ 50,700	\$ 26,100	\$ 24,600	\$ 2,500	
	10th	25	15	\$ 169	\$ 63,375	\$ 32,625	\$ 30,750	\$ 2,500	
	11th	25	24	\$ 169	\$ 101,400	\$ 52,200	\$ 49,200	\$ 2,500	
	12th	25	24	\$ 169	\$ 101,400	\$ 52,200	\$ 49,200	\$ 2,500	
		100	75		\$ 316,875	\$ 163,125	\$ 153,750	\$ 10,000	\$ 163,750
					Average cost per student				\$ 1,638

AVID at a Glance

42



What AVID is.....

- ▶ AVID is an acronym that stands for Advancement Via Individual Determination.
- ▶ AVID is an in-school academic support program for grades 4-12 that prepares students for college eligibility and success.
- ▶ AVID places academically average students in advanced classes.
- ▶ AVID levels the playing field for minority, rural, low-income, and other students without a college-going tradition in their families.
- ▶ AVID is for ALL students, but it targets those in the academic middle.
- ▶ AVID is implemented school wide and district wide.

Tracy Gaines Building at SCC

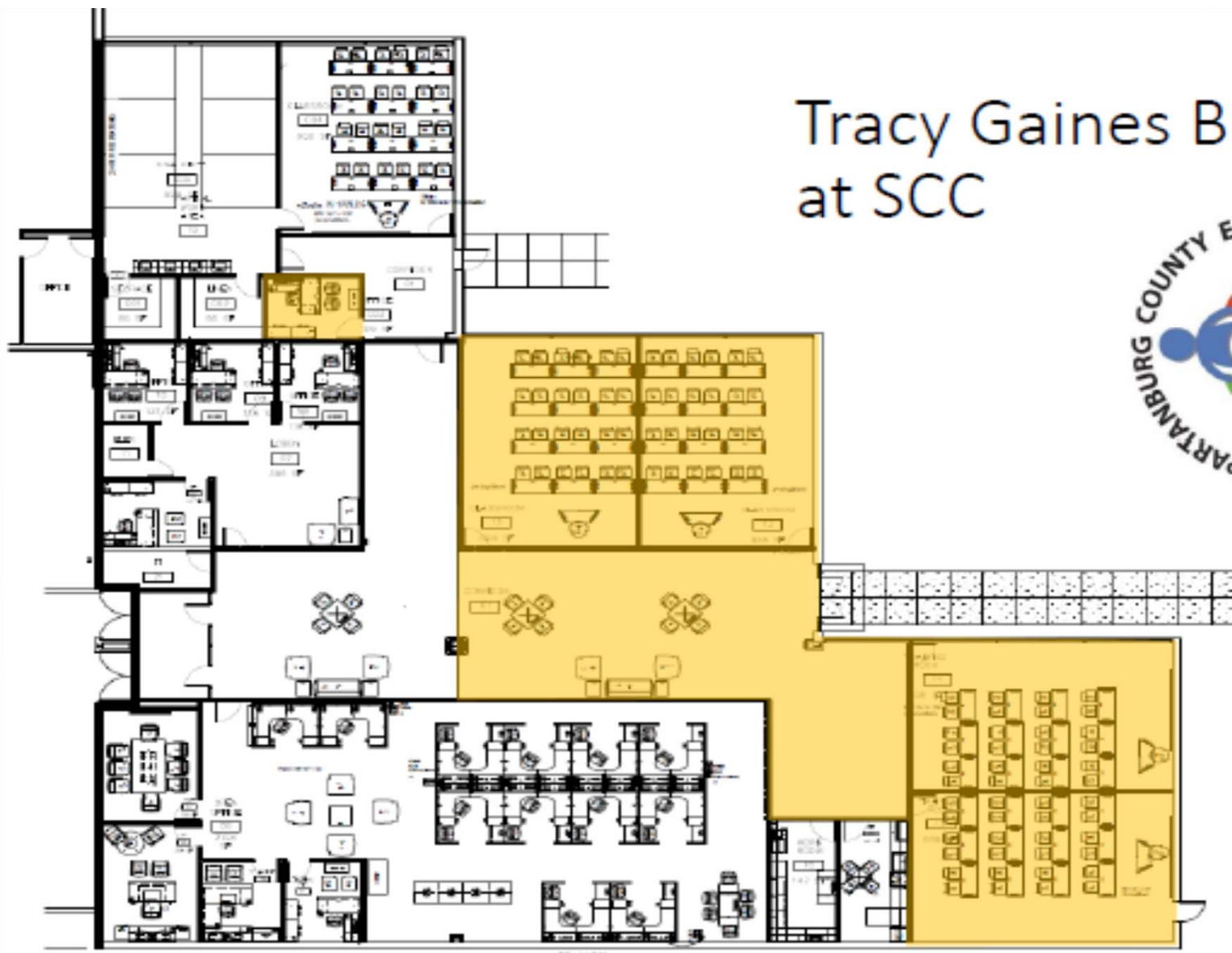

REV 12/14/2009

Spartanburg Five Students Earning Dual Credit

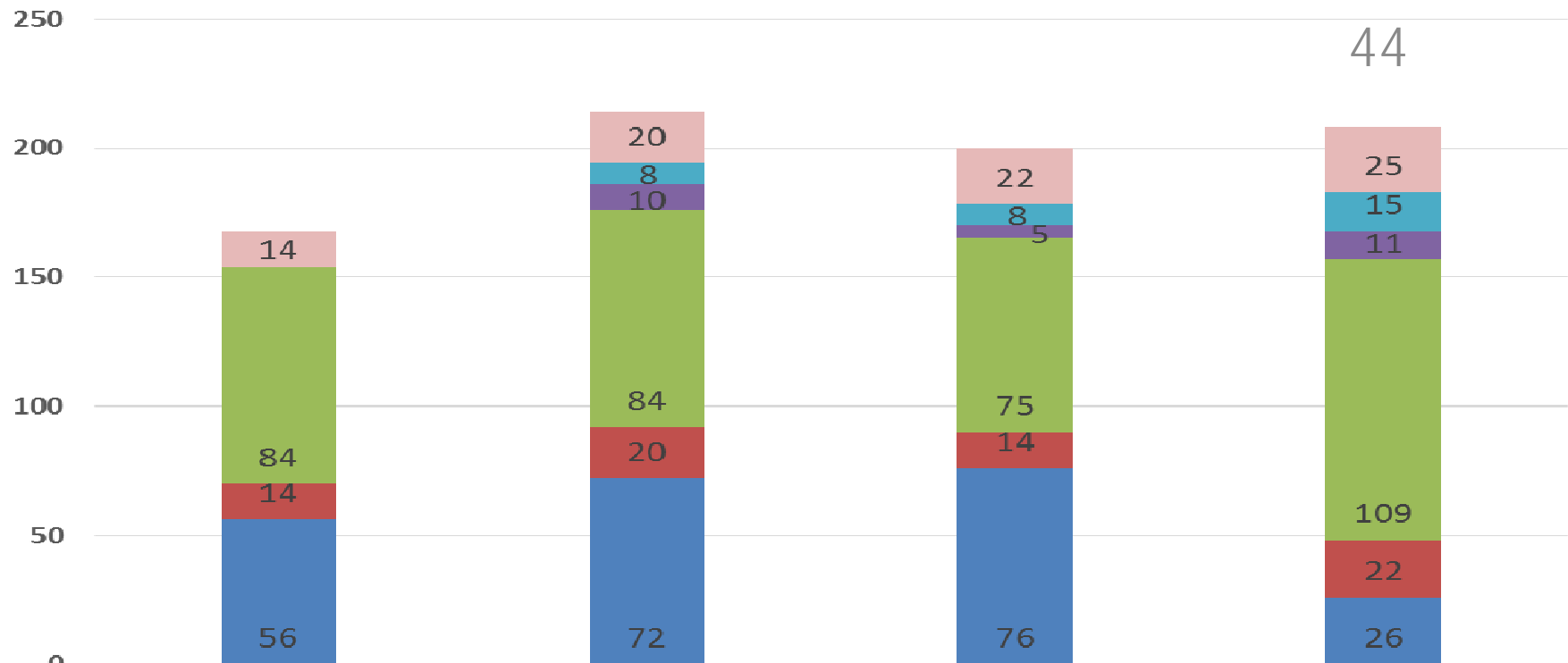

	2009-10	2010-11	2011-12	2012-13
Scholars Academy	14	20	22	25
Upstate-BHS	0	8	8	15
GTC-RDA	0	10	5	11
SCC-RDA	84	84	75	109
SCC-BHS	14	20	14	22
SCC-Tyger River	56	72	76	26